

## SIGNAL LIGHTS



- Incandescent or Xenon type
- Red, Yellow, Green and Blue lens available
- Smooth or Prism lens
- Stud or Pole mounted
- Wide range of power supply

## Order Information

The diagram illustrates the configuration of a traffic signal head using the code **ML-G-F-012-R**. Each character in the code corresponds to a specific feature, which is detailed in the tables below.

**Mounting**

<b>G</b>	Stud Mount
<b>P</b>	Pole Mount

**Lens Colors**

<b>R</b>	Red
<b>Y</b>	Yellow
<b>G</b>	Green
<b>B</b>	Blue

**Power Supply**

<b>012</b>	DC 12V
<b>024</b>	DC 24V
<b>110</b>	AC 110V
<b>220</b>	AC 220V

**Light Style**

	Rotating Light
<b>F</b>	Flashing Light
<b>S</b>	Strobe Light with Xenon Bulb

**AC 110 or 220V Only ►**

## Optional Orders

## Replacement Parts

<b>Bulb</b>	<b>MAB-T15-S-012-08</b>	12V DC, 8 Watt
	<b>MAB-T15-S-024-08</b>	24V DC, 8 Watt
	<b>MAB-T15-S-130-08</b>	110V AC, 8 Watt
	<b>MAB-T15-S-240-08</b>	220V AC, 8 Watt
<b>Xenon Bulb</b>	<b>MAB-STROBE-110-06</b>	110/220V AC, 6 Watt
<b>Lens</b>	<b>LENS-MLG-(□)</b>	Smooth Lens for Rotating Lights
	<b>LENS-MLGF/S-(□)</b>	Prism Lens for Flashing/Strobe Lights

(□): indicates color of Lens; R, Y, G or B

## Wall Mount Brackets



MAM-DS26

MAM-DS30-BLK (Black)

MAM-DS30-BGE (Beige)

**NOTE:** See **Page 14** for Dimensions.

## Specifications

Model		MLG/MLP	MLGF/MLPF	MLGS/MLPS
Bulb Type		Incandescent		Xenon
Power Supply		12VDC, 24VDC, 110VAC, 220VAC		110VAC, 220VAC
Current Draw & Wattage	12VDC	0.7A, 8W		—
	24VDC	0.3A, 8W		—
	110VAC	0.7A, 8W		0.22A, 6W
	220VAC	0.03A, 8W		0.11A, 6W
Rotation Rate		130 times/minute	—	
Flashing rate		—	80 times/minute	

## Dimensions

unit: mm

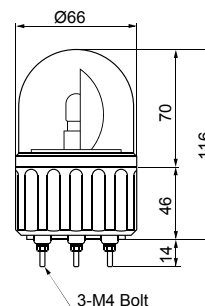

### Stud Mount Hole Layout

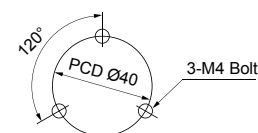

## Wiring Diagram

## Rotating & Strobe Lights

MLG-□□□-□ MLGS-□□□-□  
MLP-□□□-□ MLPS-□□□-□

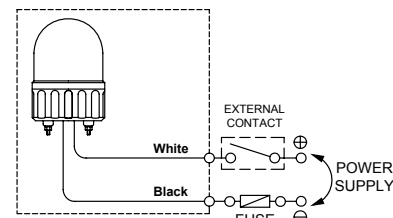

## Flashing Lights

MLGF-□□□-□ MLPF-□□□-□

